

Club Internet Web Site:  
<http://www.strcc.org>

Field Location:  
N 32.63427  
W 97.24204

# NEWS

Seven Towers R/C Club, Arlington, Texas  
Feb 2013 Volume 27 Issue 02

Mail Correspondence and Membership Dues to:

**STRCC**  
**P.O. Box 174334**  
**Arlington, Texas 76003**

## STRCC 2013 Officers

### **President:**

**Mario Gonzalez**  
magonzalez47@att.net

### **Sec. / Treasurer/Editor:**

**Larry Nelson**  
nelsonlarry63@yahoo.com

### **Vice President:**

**Pat Ensign**  
buzzardaire@gmail.com

### **Safety Officer:**

**Duane Riedel**  
staycdbr@sbcglobal.net

## Club Upcoming Events

**Club Meeting – Feb. 4<sup>th</sup> at 7:00 PM**  
**Meeting at Jerry's Hangar, see Map on**  
**the last page**

# Meeting Notes

**Our Feb. 4<sup>th</sup> Meeting is Monday  
7:00 PM, at Jerry's Hangar**

**January's Meeting** was at Jerry's Hangar, we had 10 members show up. Thanks Jerry!

We had a short business meeting.

Pat demonstrated his new Delta Wing Airplane and explained the changes made to the original model and how these affected the flight characteristics.

We had our Jan 1<sup>st</sup>, Fly In on Jan. 13<sup>th</sup>. We had beautiful weather and steady breezes out of the South. We had RC Planes, U-Control, Helicopters, Soaring, and a multi copter fly. We had food to share and a great time.

**Club Dues for 2013 are now past due!**  
**Please mail your dues to the PO Box or bring them to the meeting. The Code on the Entrance Gate will change this weekend.**  
**Only paid up members will receive the new combination!**

If you notice something or someone suspicious, please call or text the Landfill Manager, Louie Patino at 214-206-5350

**Let him know you are a member of the model airplane club. Thanks**

We remind all fliers to **use catch bottles** to contain the overflow when refueling your powered aircraft. This prevents damage to our worktables, runway, and grass. It also prevents the landfill from getting in trouble for fuel spills on the floodplain. **Do not fuel your aircraft on the worktables.**

**Club Dues for 2013 are DUE!**      **Members:**  
**\$60/year, over 63 Senior: \$40/year**

## ROOKIE RACING

Duane Riedel has changed our club's Pylon Racer Specifications to allow 40 to 46 ball bearing engines and open sport propellers. We welcome new fliers but ask that no hopped up race planes participate. The AMA maximum speed limit is 100 mph. Come out with a 40's size airplane and test your skills flying in traffic.

Duane Riedel coordinates the Rookie Races.

---

## Seven Towers Radio Control Club

### Arlington Texas

(AMA Charter No. 2421)

### Membership Application

Name: \_\_\_\_\_

Date: \_\_\_\_\_

AMA Number: (Mandatory) \_\_\_\_\_

Radio Frequencies: \_\_\_\_\_

Address: \_\_\_\_\_  
\_\_\_\_\_  
\_\_\_\_\_

Phone: \_\_\_\_\_

e-mail: \_\_\_\_\_

e-mail or paper copy newsletter: \_\_\_\_\_

Flying Experience Level:

Beginner: \_\_\_\_\_ Novice: \_\_\_\_\_

Advanced: \_\_\_\_\_

Special Interests: \_\_\_\_\_  
\_\_\_\_\_  
\_\_\_\_\_

### About The Club:

The Seven Towers RC Club (STRCC) is a relatively small club with roughly 35 members. Most of the folks are very laid back and are in the hobby strictly for pleasure. STRCC holds monthly meetings, usually the first Monday, to share info & swap stories.

We are chartered with the Academy Of Model Aeronautics (AMA) and are governed under their

Please pick up after yourself at the airfield, remove trash, and put the chairs away when finished.

**Please make sure the gate is closed behind you if you had to open it to enter or leave.**

*Larry Nelson – STRCC Secretary*

guidelines as well as some of our own club rules. The AMA provides many services but the main benefit is insurance. They provide liability coverage for each member at a very affordable rate. The cost is about \$58 per year. (That price includes a great monthly magazine)

Our club rules mandate that each person must be a current (or have at least applied for) AMA membership before becoming a STRCC member. This greatly reduces the clubs insurance rates and allows us to lower our membership costs.

The annual membership for STRCC is **\$60** per year.

Seniors 63 or greater are **\$40** per year.

To join STRCC during the year, new membership dues are prorated at \$60/year (\$6/month remaining).

Return Completed Applications to Any Club Officer or Mail to:

**STRCC**  
**P.O. Box 174334**  
**Arlington, Texas 76003**

**For more information Contact:**

**Mario Gonzalez - President**

[magonzalez47@att.net](mailto:magonzalez47@att.net)

**Larry Nelson - Club Sec./Treas.**

[nelsonlarry63@yahoo.com](mailto:nelsonlarry63@yahoo.com)

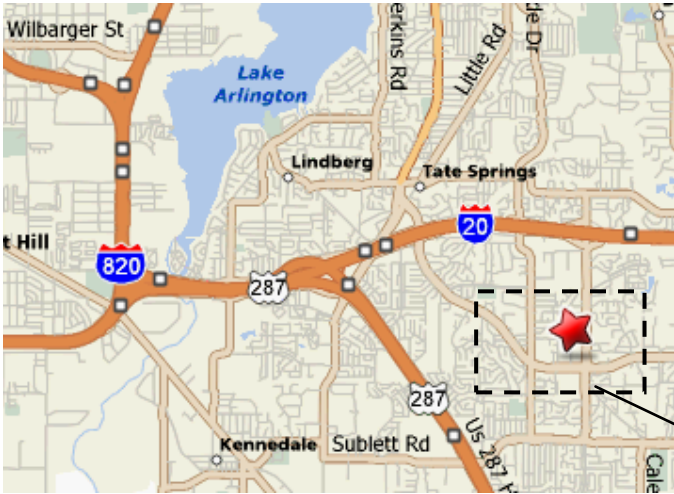

Map to  
Jerry's  
Hangar!

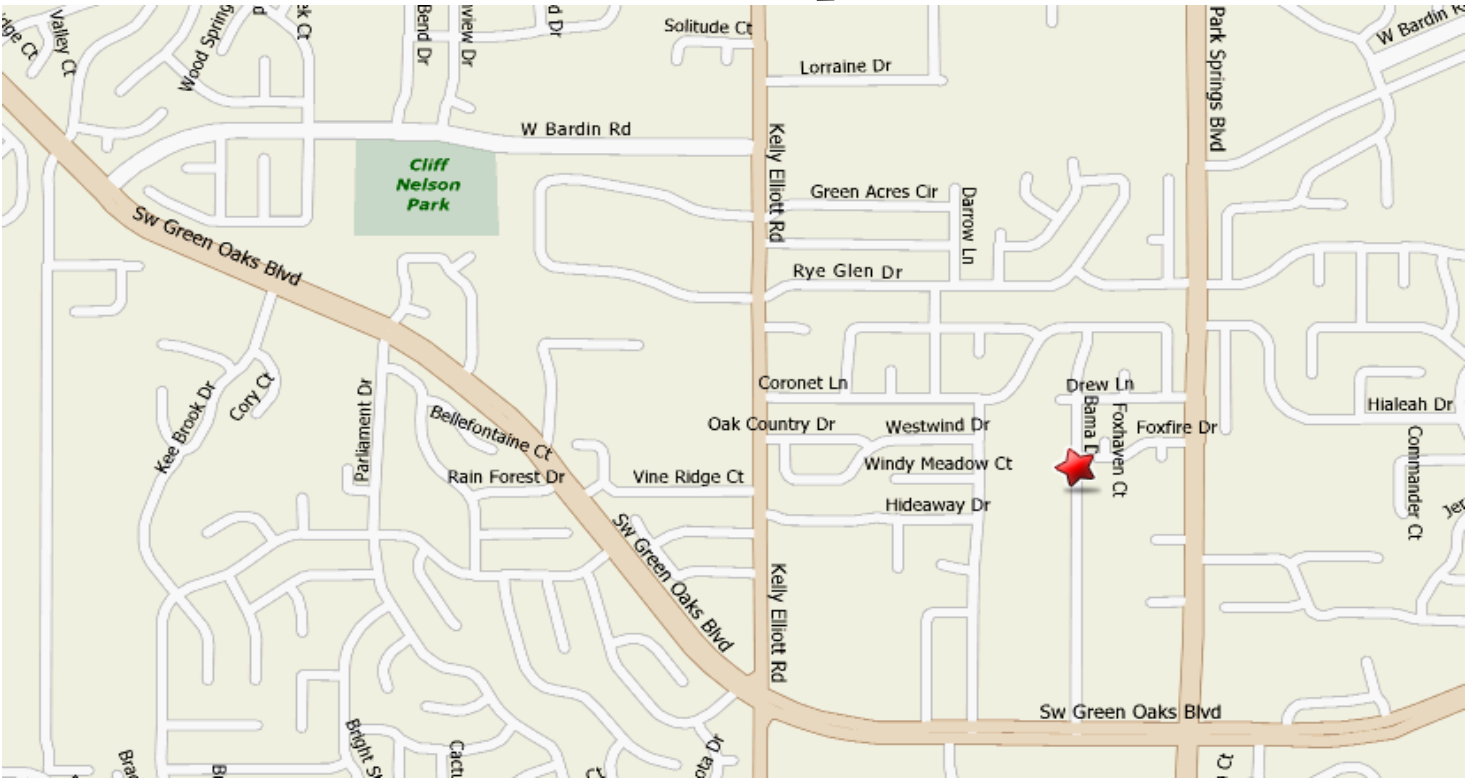

**NOTE: The next club meeting will be held  
at  
Jerry's Hangar!  
5210 Bama Dr.  
Arlington, TX 76017  
(817) 483-0321  
I-20 to Kelly Elliott/Park Springs  
Turn South on Park Springs; go past light at Indian Wells to  
Drew Lane  
Turn West (right) on Drew Lane to  
Bama Drive, turn South (left)  
Home with the white rail fence on the West side of Bama Dr.**

Pat's  
Delta  
Movies

QuickTime™ and a  
H.264 decompressor  
are needed to see this picture.

QuickTime™ and a  
H.264 decompressor  
are needed to see this picture.

QuickTime™ and a  
H.264 decompressor  
are needed to see this picture.